

Proposed Project at Mahalla-Soski, Ward No-6, Holding No-1/1, on Mouza-Nari, J.L. No-70, R.S. Plot No-667, R.S. Khatian No-8, L.R. Plot No-1504, L.R. Khatian No-44357, 3179, 3181, under Burdwan Municipality, P.S.-Burdwan, District-Purba Bardhaman

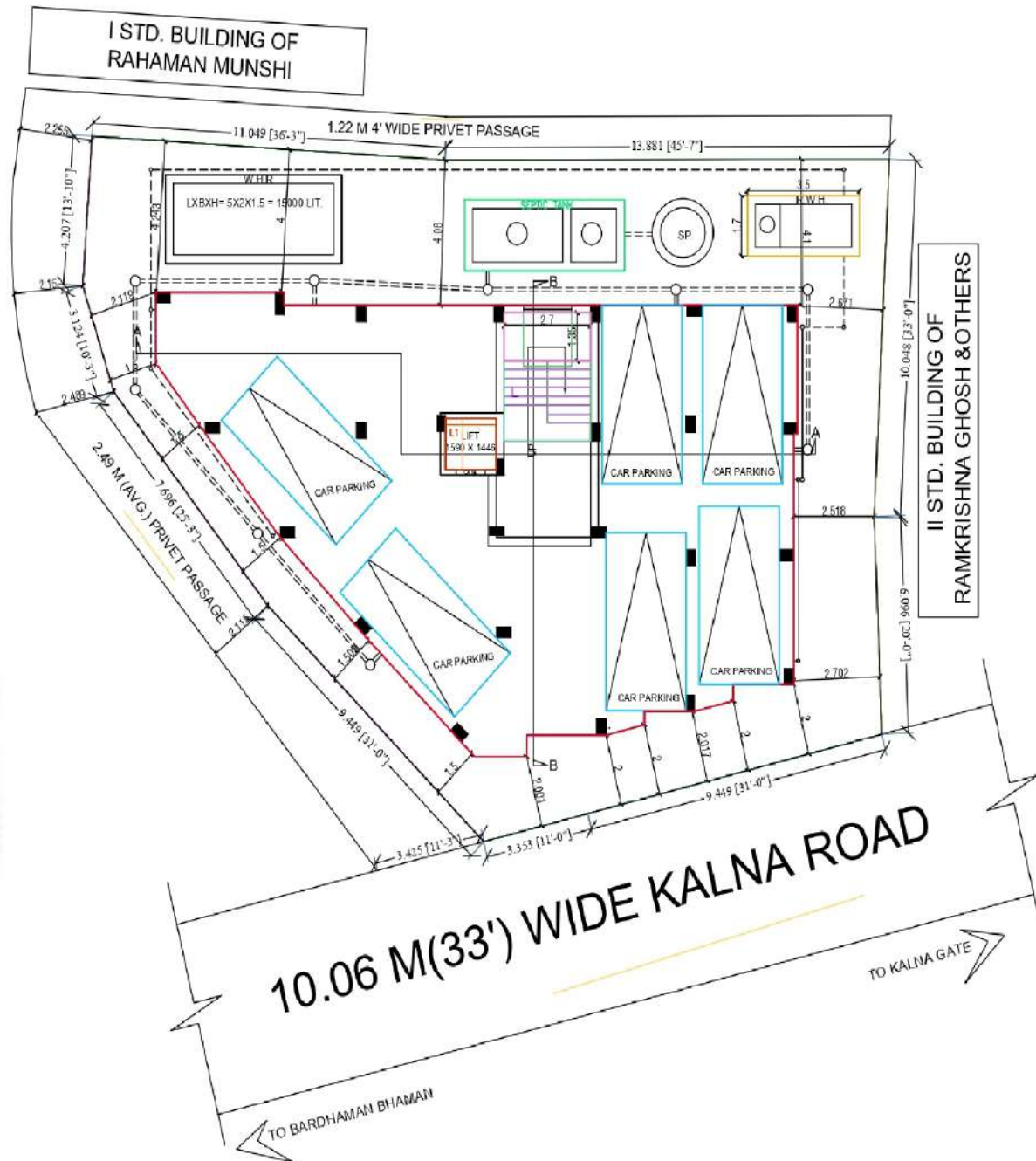

LATITUDE : 22.822089
LONGITUDE : 87.392010

SWEET HOME CONSTRUCTION

Abdus Sahed
 Partner

SIGNATURE OF OWNER